

812

813

814

4 bacs de 80 cm en brick bimuro
de 3.5 m de long. Creuse pour
effectuer la fondation 50 cm; mise
en place d'une dalle en béton 8 cm
d'épaisseur sur 30 cm de large.
Dénivellation 2.4m

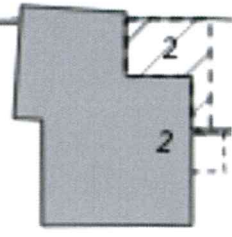
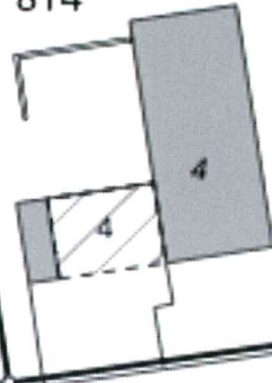
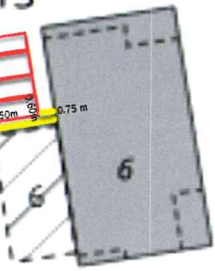
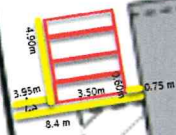

Pose muret brick bimuro. Dimension
5.7m largeur, 1.50 m de chaque côté,
hauteur 50 cm.

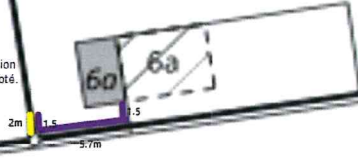

e d'En-La

